

ITL DENTAL Implant Catalog

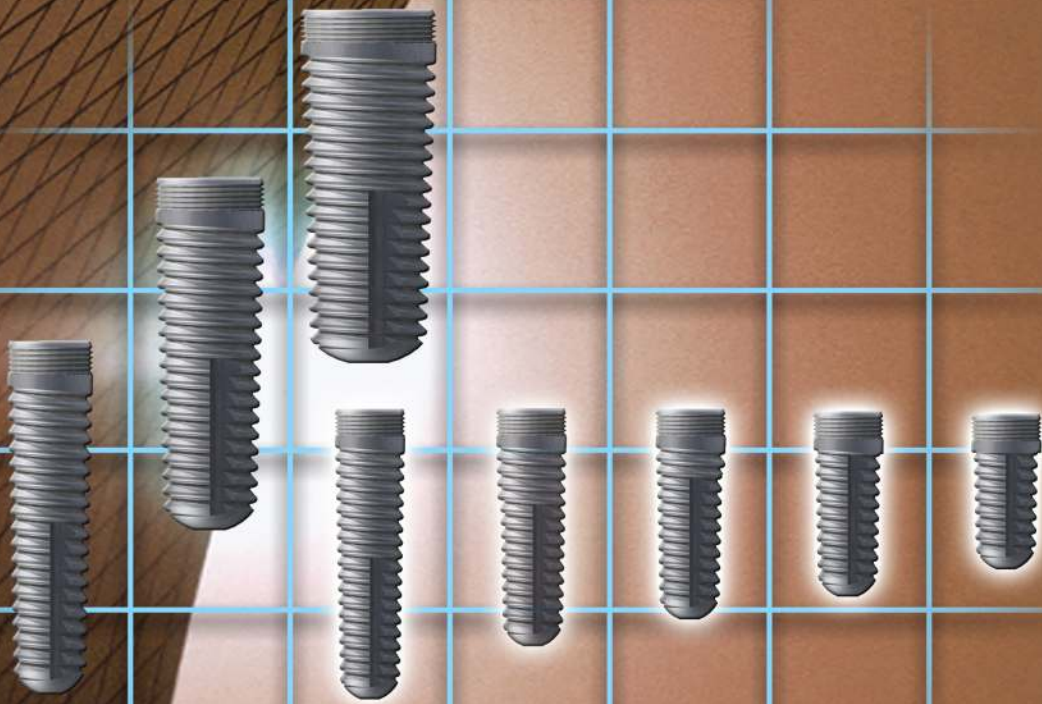

ITL DENTAL

Implant Catalog

ITL Dental was established in 1991 and is an OEM vendor of dental implants and dental implant products. The Company has supplied dental implants and dental implant products to a number of leading implant systems on a world-wide basis. Products are manufactured under a quality management system that complies with the requirements of ISO 13485.

Pricing for the products is based upon the purchase order quantity. We allow our customer to place a purchase order and withdraw from it for up to 12 months. This provides our customer the lowest price based on a larger total quantity. The total purchase order quantity has to be purchased within the 12 month period.

This catalog displays a sampling of our implant products. We have the capability to alter designs on a number of products to meet the needs of the customer. Show us what is wanted and we will quote you a price. Not all products can be altered due to regulatory restrictions.

ITL DENTAL

ITL DENTAL

Implant Catalog

Internal Hex Implants

Six Implant Diameters: |

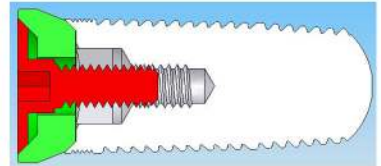
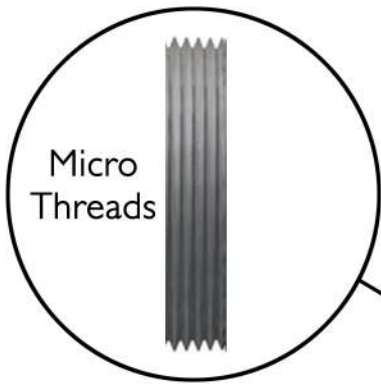
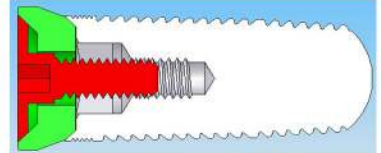
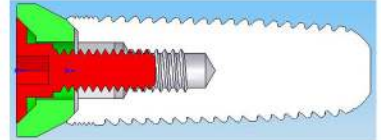
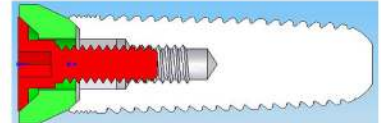
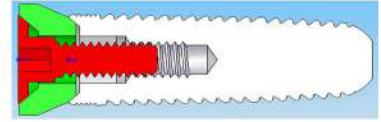
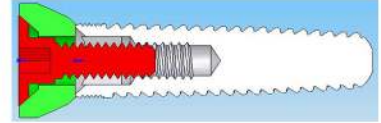

Five Internal Hex Implant Lengths



(Above renderings not to scale) Implants continued on next page...

ITL DENTAL

Internal Hex Implants

Internal Hex Implants

are compatible with a number of internal hex implant systems such as Zimmer, Implant Direct, MIS, Hi-Tec and Bio Horizons

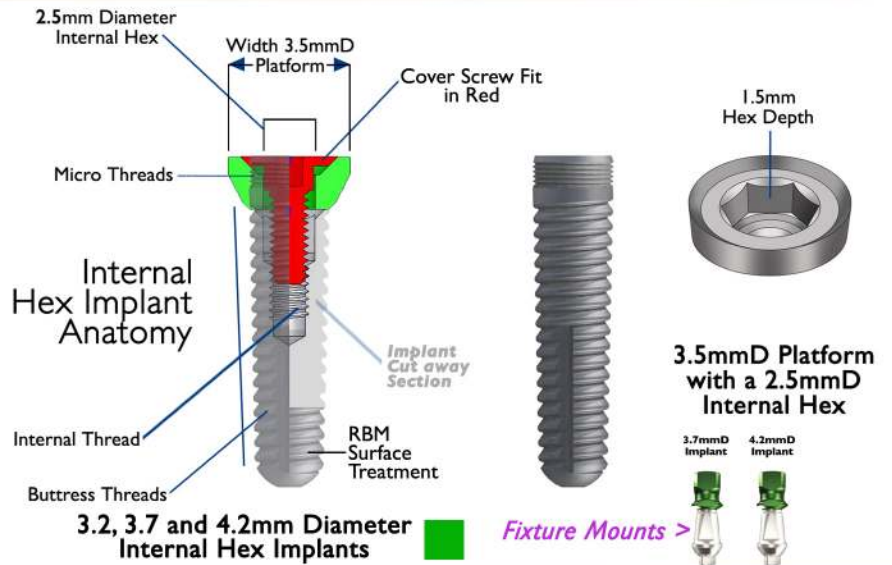

Color-coded Fixture Mounts that can also be used as transfers and final straight abutments.

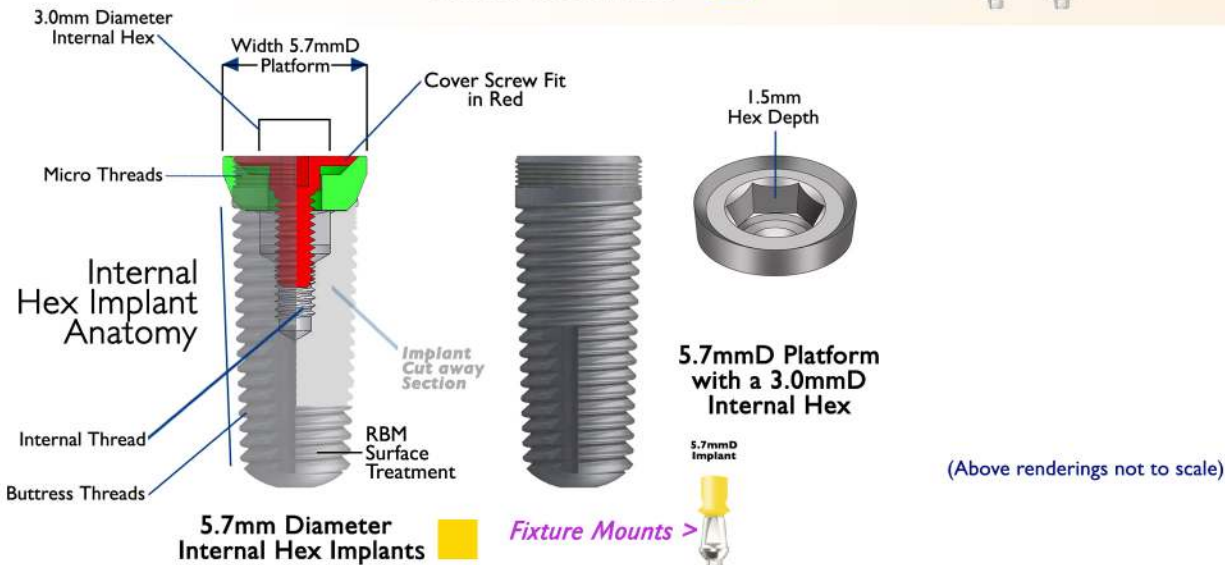
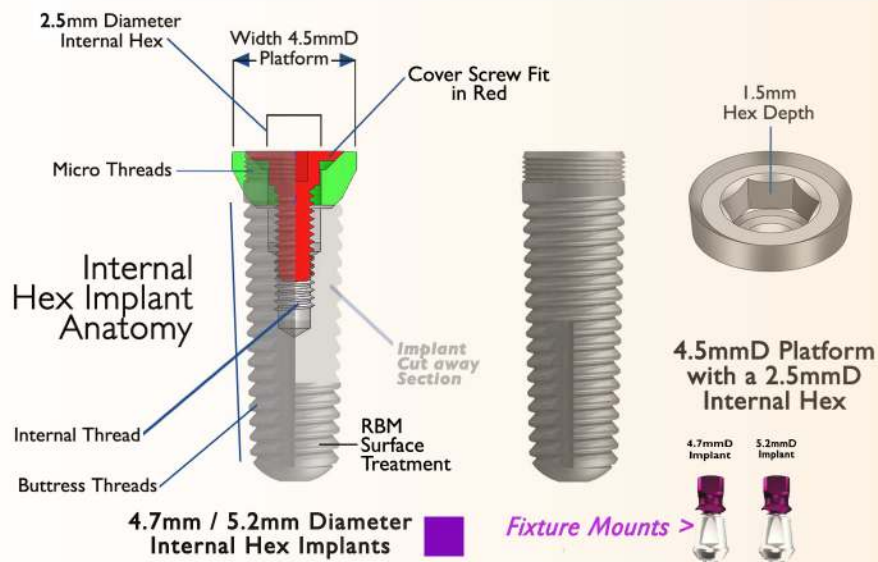

ITL DENTAL Implant Catalog

Internal Hex Packaging



(Above photos not to scale)

Implant products continued on next page...

ITL DENTAL

31 Peters Canyon, Irvine, CA 92606 800.277.0073 949.223.8950 FAX: 949.223.8960 www.itldental.com sales@itldental.com

ITL DENTAL Implant Catalog

External Hex Implants

Available Diameters



3.3



3.4



3.75



4.25



5.0mm

Available Lengths



8



10



11.5



13



15



18



20mm

Implant Assembly



(Above photos not to scale)

Implant products continued on next page...

ITL DENTAL

31 Peters Canyon, Irvine, CA 92606 800.277.0073 949.223.8950 FAX: 949.223.8960 www.itldental.com sales@itldental.com

Implant Instrumentation

SURGICAL DRILLS

The step drills are titanium carbon nitride coated to improve the visualization of the score lines and to increase cutting lubricity. They are available in 7 diameters. The first 4mm is the smaller diameter stepping up to the larger diameter.



Pilot Drill PD White 2320 Grey 2823 Green 3428 Pink 3834 Purple 4438 Blue 4844 Yellow 5448

Drill Sequence Chart

Drill Code	Size	Color	Platform/ Implant Dia							
			3.5/3.2	3.5/3.7	3.5/4.2	4.5/4.7	4.5/5.2	5.7/5.7	5.7/7.0	
SD2320	2.3/2.0	White	X	X	X	X	X	X	X	X
SD2823	2.8/2.3	Grey	X	X	X	X	X	X	X	X
SD3428	3.4/2.8	Green		X	X	X	X	X	X	X
SD3834	3.8/3.4	Pink			X	X	X	X	X	X
SD4438	4.4/3.8	Purple				X	X	X	X	X
SD4844	4.8/4.4	Blue					X	X	X	X
SD5448	5.4/4.8	Yellow							X	X

Last drill is used in dense bone situations. For soft bone, delete last drill.

(Above photos not to scale)

Implant Instrumentation
continued on next page...

ITL DENTAL

Implant Instrumentation



Dyna•Torq Wrenches 10, 20, 30, 32 and 35 Ncm

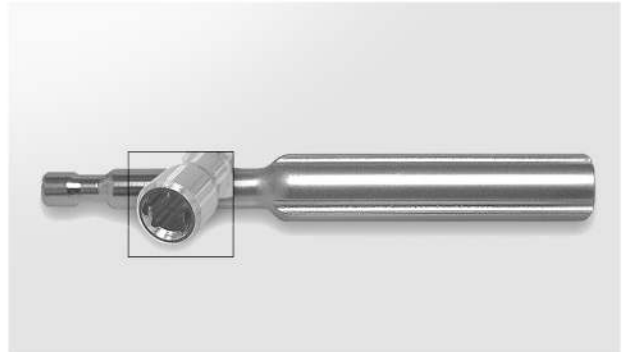

4mm Square Screw Driver Handle



Implant Mount Driver



Precise Adjustable Torque Wrench
With Nine Settings:
15, 20, 25, 30, 35, 40, 45,
50 and 60 Ncm



Direction Indicators

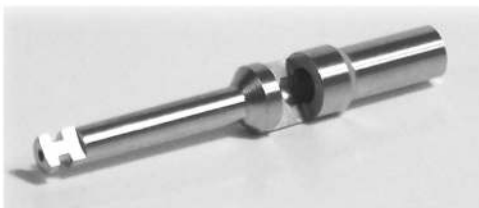

Drill Extension



4mm Ratchet Wrench



6mm Ratchet Wrench

(Above photos not to scale)

Implant Instrumentation
continued on next page...

Implant Instrumentation

Implant Drivers, Extensions & Adaptors

SHAFT LENGTHS:

SHORT: 6.4mm

LONG: 12.7mm



Implant Drivers, Extensions & Adaptors			SHAFT LENGTHS:			TIPS	SPECIALTY DRIVERS	SPECS
TIPS	HEX DRIVERS	SPECS	TIPS	HEX DRIVERS	SPECS			
		.035 Hex Tapered Short: HCT Long: HCLT			.070 Hex Long: HTSI			.048 / .050 Hex Short: HNHTS Long: HNHTL
		.035 Hex Short: HC Long: HCL			.080 Hex Short: HU Long: HUL			Torx Short: PROC-S Long: PROC-L NobelBiocare
		.040 Hex Tapered Short: HSM Long: HSML			2.5mm Hex Short: H25S Long: H25L			Torx Short: ITIS Long: ITL ITI/Straumann
		.048 Hex Tapered Short: HNT Long: HNLT			Hex Driver for internal Hex Long: IHDL			4mm Square Head Short Triangle Driver
		.048 Hex Short: HN Long: HNL			Hex Driver for internal Hex Short: IHDS			4mm Square Head Long Triangle Driver
		.050 Hex Tapered Short: HTT Long: HTLT			Implant Driver 5.7mm internal Hex Long: IHD5L			Female Driver .080 Hex Short: HFD
		.052 Hex Tapered Short: HT2SMT Long: HT2SMLT			Implant Driver 5.7mm internal Hex Short: IHD5S			TG Post for 3i/ITI/Straumann TGDN
		.062 Hex Short: HS Long: HSL	<p>To order call: 800.277.0073 or contact us at: sales@itldental.com For additional implant-related product information, visit our website at: www.itldental.com</p>					4mm Square Head Short Triangle Driver
								4mm Square Head Long Triangle Driver

(Product photos not to scale)

All product names are trademarks of their respective companies.

Implant Instrumentation

Implant Drivers, Extensions & Adaptors

SHAFT LENGTHS:

SHORT: 6.4mm

LONG: 12.7mm



TIPS	LATCH STYLE DRIVERS	SPECS	TIPS	LATCH STYLE DRIVERS	SPECS	TIPS	ADAPTORS	SPECS
		2.5mm Latch Style Hex Driver Short: H25LS Long: H25LL			Implant Latch Driver for Internal Hex Long: IHD5RAL			NA NobelBiocare Torque Wrench Adaptor
		Latch Style Torx Driver PROCLS NobelBiocare			Implant Latch Driver for Internal Hex Short: IHD5RAS			ITA ITI/Straumann Torque Wrench Adaptor
		.050 Latch Style, Square Driver T17/24			Implant Latch Driver for 5.7mm Internal Hex Long: IHD5RAL			LS Latch to Square Adaptor
		.040 Latch Style, Tapered Hex Driver H40RA			Implant Latch Driver for 5.7mm Internal Hex Short: IHD5RAS	MANUAL KNOB		SPECS
		.048 Latch Style, Tapered Hex Driver T10/24	TIPS EXTENSIONS SPECS					3/8" Extension EX
		.050 Latch Style, Tapered Hex Driver HTRA			5/8" Extension EXL			Thumb Knob
		4mm Latch Style Triangle Driver	<p><i>To order call: 800.277.0073 or contact us at: sales@itldental.com For additional implant-related product information, visit our website at: www.itldental.com</i></p>					

(Product photos not to scale)

All product names are trademarks of their respective companies.

Implant Instrumentation

Bone Expander Kit

Bone Expander Kits are available with either 5 or 6 expanders.

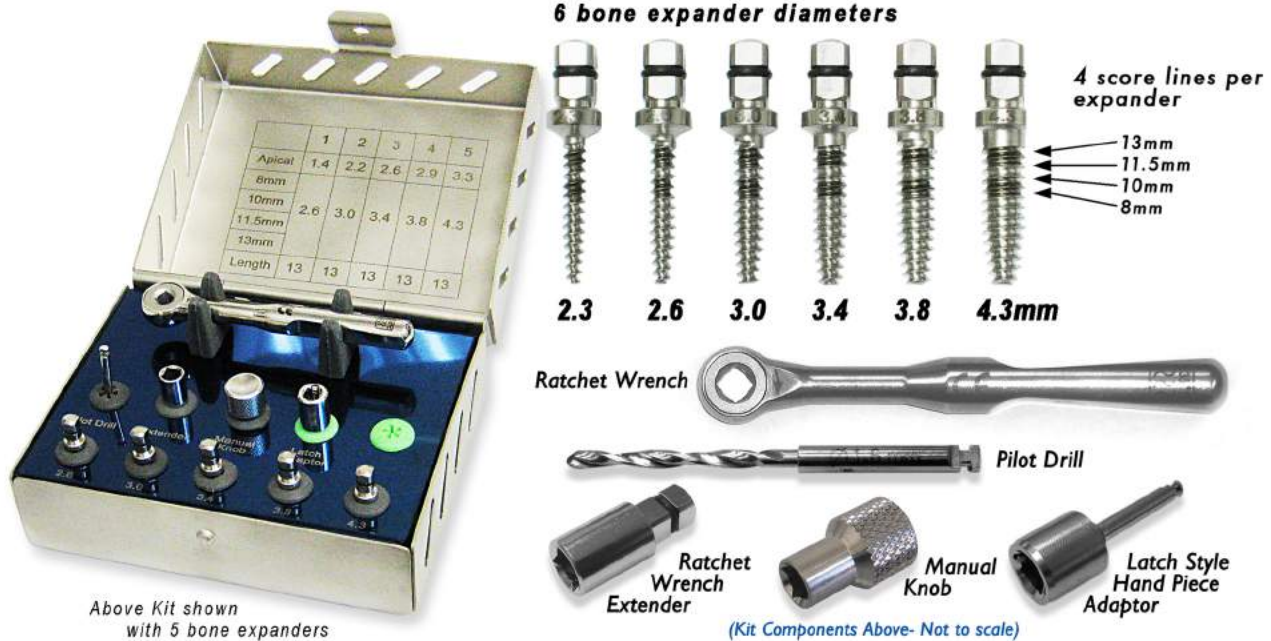

An Alternative to Osteotomes

Bone expander drills are an alternative to osteotomes for the expansion and condensing of the atrophic mandible and maxilla in preparation for dental implant insertions. Expanders are also an alternative to the maxillary sinus elevation technique.

Surgical Drama Decreased

Expanders are driven into the bone with a ratchet wrench or low speed hand piece. This decreases the surgical trauma of osteotomes. Bone expanders improve the clinical success by improving stability, maintaining bone density and increasing fixation.

What the Kit Includes

The Bone Expander Kit from ITL Dental includes 5 or 6 bone expanders, ratchet wrench, pilot drill, ratchet wrench extender, hand piece latch adaptor and a manual knob for finger usage. The kit is autoclavable.

Implant Instrumentation

Basic Surgical Drilling Kit



**The ITL DENTAL
Basic Surgical Drilling Kit**



The Surgical Drilling Kit shown here includes a Ratchet Wrench, Pilot Drill, Paralleling Pin, Ratchet Extension Driver, Motor Driver, 2.5 Hex Driver along with the following Drills: 2.0/2.3; 2.3/2.8; 2.8/3.4; 3.4/3.8 and 3.8/4.4mm Drills. The Kit is fully autoclaveable and constructed of high-grade stainless steel.

Autoclavable:

This kit may be autoclaved. Follow the sterilizer manufacturer's recommended procedure while observing the following cautions:

Caution:

- **Do not** exceed 275° (175°C)
 - **Do not** submerge in any solution
 - **Do not** use ultrasonic devices
 - **Do not** autoclave for extended periods of time (i.e. overnight).
- Extended autoclaving should not be confused with repeated autoclaving. Repeated autoclaving will not harm the product.

ITL DENTAL

Implant Instrumentation

Advanced Surgical Drilling Kit



**The
Advanced
Surgical Drilling Kit**

The Advanced Surgical Drilling Kit shown here includes: Ratchet Wrench, Straight Handle, Drill Extension, Implant Mount Driver, Thumb Knob, Long and Short .048 Hex Driver, Long and Short .050 Hex Driver, Long and Short 2.5mm Hex Driver, 4, Direction Indicators, Pilot Drill, and 7, Surgical Drills: 2.3/2.0, 2.8/2.3, 3.4/2.8, 3.8/3.4, 4.4/3.8, 4.8/4.4, and 5.4/4.8. The Kit is autoclaveable.

Autoclaving:

This kit may be autoclaved. Follow the sterilizer manufacturer's recommended procedure while observing the following cautions:

Caution:

- **Do not** exceed 275° (175°C)
 - **Do not** submerge in any solution
 - **Do not** use ultrasonic devices
 - **Do not** autoclave for extended periods of time (i.e. overnight).
- Extended autoclaving should not be confused with repeated autoclaving. Repeated autoclaving will not harm the product.

Prosthetic Catalog Index

Implant Items		1 - 13
Section 1	OLS	15 - 16
Section 2	MLS SYSTEM	17 - 18
Section 3	MLS UNIT RESTORATION	19 - 20
Section 4	BALL ATTACHMENT	21 - 23
Section 5	TEMPORARY ABUTMENTS	24
Section 6	TITANIUM ABUTMENTS	25 - 27
Section 7	ZIRCONIA ABUTMENTS	28
Section 8	CASTING ABUTMENTS	29
Section 9	ANALOG	30
Section 10	3D SCANNING INTERFACE	31
Section 11	HEALING CAP	32
Section 12	PROSTHETIC SCREWS	33
Section 13	TRANSFER	34

STRAIGHT OLS ABUTMENT SYSTEM

Over Denture Attachment in connection with implants

OLS ABUTMENT SYSTEM

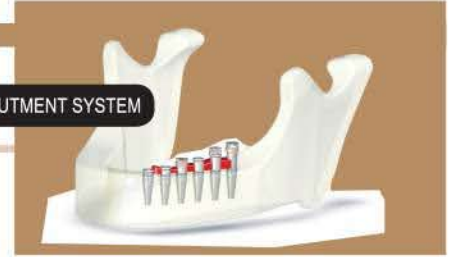

OLS ABUTMENT SYSTEM MINOR - RETAINED OVER DENTURE ABUTMENTS

Abutment bases in connection with implants
3.5 Platform



Cat. No.	WCM-0000	WCM-0010	WCM-0020	WCM-0030	WCM-0040	WCM-0050
Designation	0mm Aesthetic Height	1mm Aesthetic Height	2mm Aesthetic Height	3mm Aesthetic Height	4mm Aesthetic Height	5mm Aesthetic Height

for FULL SET add SPE to Cat No.

OLS ABUTMENT SYSTEM - MINOR SET PEEK

Abutment bases with peek attachment and housing covers
3.5 Platform

FULL SET



Cat. No.	WCM-0000 - SPE	WCM-0010 - SPE	WCM-0020 - SPE	WCM-0030 - SPE	WCM-0040 - SPE	WCM-0050 - SPE
Designation	0mm Aesthetic Height	1mm Aesthetic Height	2mm Aesthetic Height	3mm Aesthetic Height	4mm Aesthetic Height	5mm Aesthetic Height



OLS ABUTMENT SYSTEM - ACCESSORIES



Cat. No.	WCH-5628	WCH-4823	WCP-2348-H	WCPS-2348-H	WCP-2348	SCH-8540	TWC-1105	WCT-900	AWC-1301
Designation	STAINLESS STEEL HOUSING COVER	STAINLESS STEEL HOUSING	Hard Housing PEEK Attachment	Soft Housing PEEK Attachment	DIRECT PEEK Attachment	SILICON Sealed RING	TRANSFER for OLS	OLS ABUTMENT SYSTEM Tool	ANALOG for OLS



OLS ABUTMENT SYSTEM ON MLS SYSTEM

ANGULAR OLS ABUTMENT SYSTEM CONCEPT 9°,18°,30° OLS Over Denture Attachment - SETS

9° OLS ABUTMENT SYSTEM ANGULAR MLS SYSTEM CONCEPT OLS Angular Over Denture Attachment - SET



Cat. No.	WCA-0920 - M	WCA-0930 - M	WCA-0940 - M	WCA-0950 - M
Designation	9° OLS angular MLS System 2 mm Height	9° OLS angular MLS System 3 mm Height	9° OLS angular MLS System 4 mm Height	9° OLS angular MLS System 5 mm Height



Cat. No.	OLH 0035
Designation	Orienting Lead Holder

18° OLS ABUTMENT SYSTEM ANGULAR MLS SYSTEM CONCEPT OLS Angular Over Denture Attachment - SET



Cat. No.	WCA-1820 - M	WCA-1830 - M	WCA-1840 - M	WCA-1850 - M
Designation	18° OLS angular MLS System 2 mm Height	18° OLS angular MLS System 3 mm Height	18° OLS angular MLS System 4 mm Height	18° OLS angular MLS System 5 mm Height

1 OLS
Color no. 1
Internal Hex

30° OLS ABUTMENT SYSTEM ANGULAR MLS SYSTEM CONCEPT OLS Angular Over Denture Attachment - SET



Cat. No.	WCA-3020 - M	WCA-3030 - M	WCA-3040 - M	WCA-3050 - M
Designation	30° OLS angular MLS System 2 mm Height	30° OLS angular MLS System 3 mm Height	30° OLS angular MLS System 4 mm Height	30° OLS angular MLS System 5 mm Height

Designation info for
Angular MLS System Adaptors:

- Internal Hex:
-  3.5 platform = WCA-... - M
 -  4.5 platform = WCA-... - W

ITL DENTAL

Prosthetic Catalog

ANGULAR MLS SYSTEM CONCEPT 9°,18°,30° MLS Unit Items Over Denture Attachment

MLS SYSTEM

AESTHETIC MINOR UNIT - System Adaptor
Angular MLS System Adaptor 9°,18°,30°
3.5 Platform



Cat. No.	EMU-0910	EMU-1810	EMU-3010
Designation	9° ANGLE MLS SYSTEM Adaptor	18° ANGLE MLS SYSTEM Adaptor	30° ANGLE MLS SYSTEM Adaptor



Cat. No.	OLH 0035
Designation	Orienting Lead Holder

WIDE UNIT - System Adaptor
Angular MLS System Adaptor 9°,18°,30°
4.5 Platform



Cat. No.	EWU-0910	EWU-1810	EWU-3010
Designation	9° ANGLE MLS SYSTEM Adaptor	18° ANGLE MLS SYSTEM Adaptor	30° ANGLE MLS SYSTEM Adaptor

ANGLE AND HEIGHT GAUGE

2 MLS SYSTEM CONCEPT

Color no. 2
Internal Hex



Cat. No.	GAHM-00	GAHM-09	GAHM-18	GAHM-30	GAHM-SET
Designation	Straight gauge	9° Angle gauge	18° Angle gauge	30° Angle gauge	Set include full range of gauges

OLS ABUTMENT SYSTEM CONNECTION OLS Connection for MLS System Concept



Cat. No.	WCC-0020	WCC-0030	WCC-0040	WCC-0050
Designation	2 mm CONNECTION MLS SYSTEM OLS	3 mm CONNECTION MLS SYSTEM OLS	4 mm CONNECTION MLS SYSTEM OLS	5 mm CONNECTION MLS SYSTEM OLS



OLS

OLS ABUTMENT SYSTEM - ACCESSORIES



Cat. No.	WCH-5628	WCH-4823	WCP-2348-H	WCPS-2348-H	WCP-2348	SCH-8540	TWC-1105	WCT-900	AWC-1301
Designation	STAINLESS STEEL HOUSING COVER	STAINLESS STEEL HOUSING	Hard Housing PEEK Attachment	Soft Housing PEEK Attachment	DIRECT PEEK Attachment	SILICON Sealed RING	TRANSFER for OLS	OLS Tool	ANALOG for OLS

ITL DENTAL

Prosthetic Catalog

BALL MLS SYSTEM ANGULAR

Ball attachment connection for MLS System Concept



Cat. No.	BMA-0020	BMA-0030	BMA-0040	BMA-0050
Designation	2 mm CONNECTION MLS SYSTEM BALL	3 mm CONNECTION MLS SYSTEM BALL	4 mm CONNECTION MLS SYSTEM BALL	5 mm CONNECTION MLS SYSTEM BALL

BALL Attachment- Accessories



Cat. No.	BHM-5032	BIS-0025
Designation	Stainless Steel Housing	Silicon Insert



MLS SYSTEM UNIT CONNECTION

Screwed in Connection for MLS System Concept

MLS SYSTEM

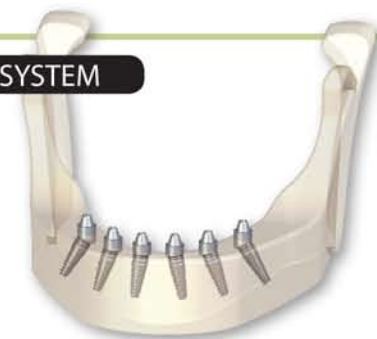

Cat. No.	MUC-0021	MUC-0031	MUC-0041	MUC-0051
Designation	2 mm CONNECTION MLS SYSTEM	3 mm CONNECTION MLS SYSTEM	4 mm CONNECTION MLS SYSTEM	5 mm CONNECTION MLS SYSTEM

MLS-UNIT ACCESORIES



Cat. No.	PSU-0032	TSU-1250	TMU-0532	TMU-1200	TMU-8005	WQP-0011	HCC-4550	AMU-1201	SSU-1624
Designation	Plastic Sleeve screw included	Titanium Sleeve screw included	Titanium Short Sleeve screw included	Open Tray Transfer screw included	Close tray Transfer	Plastic for Close tray Transfer	Healing cap for MLS Unit	Analog for MLS Unit	3D Scanning Device



SMU-4023
Screw for MLS
Unit Sleeve

NOTE: It is recommended to purchase additional screws.

ITL DENTAL

Prosthetic Catalog

MLS SYSTEM STRAIGHT AESTHETIC ABUTMENTS

Abutments with smooth, non locking surface for MLS-Unit restorations

AESTHETIC MINOR UNIT

Straight MLS-Unit
3.5 platform



Cat. No.	EMU-0011	EMU-0021	EMU-0031	EMU-0041	EMU-0051	EMU-0061
Designation	1mm height	2mm height	3mm height	4mm height	5mm height	6mm height

AESTHETIC WIDE UNIT

Straight MLS-Unit
4.5 platform



Cat. No.	EWU-0011	EWU-0021	EWU-0031	EWU-0041	EWU-0051	EWU-0061
Designation	1mm height	2mm height	3mm height	4mm height	5mm height	6mm height

SMU-4023
Screw for MLS
Unit Sleeve

MLS-UNIT - ACCESORIES



Cat. No.	PSU-0032	TSU-1250	TMU-0532	TMU-1200	TMU-8005	WQP-0011	HCC-4550	AMU-1201	SSU-1624
Designation	Plastic Sleeve screw included	Titanium Sleeve screw included	Titanium Short Sleeve screw included	Open Tray Transfer	Close tray Transfer	Plastic for Close tray Transfer	Healing cap for MLS Unit	Analog for MLS Unit	3D Scanning Device

OVER DENTURE ABUTMENTS

For single tooth restorations

Over Denture Abutments with Hex Locking for single tooth restorations.

AESTHETIC CONNECTION ABUTMENT
with hex for Retention and positioning



Cat. No.	ECA-6005	ECA-6015	ECA-6025
Designation	0.5mm height	1.5mm height	2.5mm height
Related screw	SCS - 3011	SCS - 3012	SCS - 3013

PLASTIC AESTHETIC SLEEVE



Cat. No.	PES-1240	PES-1240 R
Designation	Plastic for ECA hex base	Plastic for ECA round base

ANGULAR MLS SYSTEM CONCEPT 9°,18°,30° MLS Unit Over Denture Attachment

9° ANGULAR MLS SYSTEM UNIT CONCEPT Aesthetic MLS Unit Angular Over Denture Attachment - SET



Cat. No.	EMA-0921-M	EMA-0931-M	EMA-0941-M	EMA-0951-M
Designation	9° Angular MLS System - H02	9° Angular MLS System - H03	9° Angular MLS System - H04	9° Angular MLS System - H05

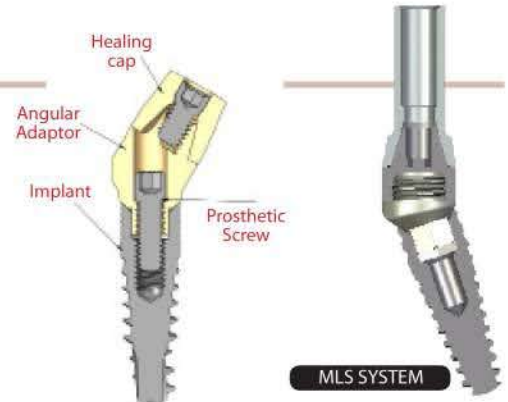

MLS SYSTEM

18° ANGULAR MLS SYSTEM UNIT CONCEPT Aesthetic MLS Unit Angular Over Denture Attachment



Cat. No.	AMU-1801-M	AMU-1811-M	AMU-1821-M	EMA-1831-M	EMA-1841-M	EMA-1851-M	EMA-1861-M
Designation	18° Angular MLS System Unit - H00	18° Angular MLS System Unit - H01	18° Angular MLS System Unit - H02	18° Angular MLS System Unit - H03	18° Angular MLS System Unit - H04	18° Angular MLS System Unit - H05	18° Angular MLS System Unit - H06



30° ANGULAR MLS SYSTEM UNIT CONCEPT Aesthetic MLS Unit Angular Over Denture Attachment



Cat. No.	AMU-3001-M	AMU-3011-M	AMU-3021-M	EMA-3031-M	EMA-3041-M	EMA-3051-M	EMA-3061-M
Designation	30° Angular MLS System Unit - H00	30° Angular MLS System Unit - H01	30° Angular MLS System Unit - H02	30° Angular MLS System Unit - H03	30° Angular MLS System Unit - H04	30° Angular MLS System Unit - H05	30° Angular MLS System Unit - H06



3 MLS SYSTEM RESTORATION

Color no. 3
Internal Hex

* MLS-UNIT ACCESSORIES → SEE PREVIOUS PAGE

Designation info for Angular MLS System Adaptors:

Internal Hex:



3.5 platform = EMA-... - M



4.5 platform = EMA-... - W

Over Denture Ball Attachment in Connection with Implants

BALL MINOR STRAIGHT 3.5 Platform Dia. 4 mm



Cat. No.	BMS-4010	BMS-4020	BMS-4030	BMS-4040	BMS-4050	BMS-4060
Designation	without cap 1mm height	without cap 2mm height	without cap 3mm height	without cap 4mm height	without cap 5mm height	without cap 6mm height

BALL MINOR SET -...- SILICON 3.5 Platform Dia. 4 mm

FULL SET



Cat. No.	BMT-0010-S	BMT-0020-S	BMT-0030-S	BMT-0040-S	BMT-0050-S	BMT-0060-S
Designation	with stainless housing & silicon insert	with stainless housing & silicon insert	with stainless housing & silicon insert	with stainless housing & silicon insert	with stainless housing & silicon insert	with stainless housing & silicon insert

BALL HOUSING MINOR / BALL INSERT SILICON



Cat. No.	BHM-5032	BIS-0025
Designation	Stainless housing	Silicon insert

4 BALL ATTACHMENT
Color no. 4
Internal Hex

ITL DENTAL

Prosthetic Catalog

BALL WIDE STRAIGHT 4.5 Platform



Cat. No.	BWS-4010	BWS-4020	BWS-4030	BWS-4040	BWS-4050	BWS-4060
Designation	without cap 1mm height	without cap 2mm height	without cap 3mm height	without cap 4mm height	without cap 5mm height	without cap 6mm height

BALL WIDE SET -...- SILICON 4.5 Platform



Cat. No.	BWT-0010-S	BWT-0020-S	BWT-0030-S	BWT-0040-S	BWT-0050-S	BWT-0060-S
Designation	with stainless housing & silicon insert	with stainless housing & silicon insert	with stainless housing & silicon insert	with stainless housing & silicon insert	with stainless housing & silicon insert	with stainless housing & silicon insert

BALL HOUSING MINOR / BALL INSERT SILICON



Cat. No.	BHM-5032	BIS-0025
Designation	Stainless housing	Silicon insert

4 BALL ATTACHMENT

Color no. 4
Internal Hex

ANGULAR MLS SYSTEM CONCEPT 9°,18°,30° Angular Ball Attachment - Set



9° BALL MINOR ANGULAR MLS SYSTEM CONCEPT 3.5 Platform



Cat. No.	BMA-0920-S	BMA-0930-S	BMA-0940-S	BMA-0950-S
Designation	with stainless housing & silicon insert 2mm height	with stainless housing & silicon insert 3mm height	with stainless housing & silicon insert 4mm height	with stainless housing & silicon insert 5mm height

18° BALL MINOR ANGULAR MLS SYSTEM CONCEPT 3.5 Platform



Cat. No.	BMA-1820-S	BMA-1830-S	BMA-1840-S	BMA-1850-S
Designation	with stainless housing & silicon insert 2mm height	with stainless housing & silicon insert 3mm height	with stainless housing & silicon insert 4mm height	with stainless housing & silicon insert 5mm height

Designation info for
Angular MLS System Adaptors:

Internal Hex:
3.5 platform = EMA-... - M
4.5 platform = EMA-... - W

30° BALL MINOR ANGULAR MLS SYSTEM CONCEPT 3.5 Platform



Cat. No.	BMA-3020-S	BMA-3030-S	BMA-3040-S	BMA-3050-S
Designation	with stainless housing & silicon insert 2mm height	with stainless housing & silicon insert 3mm height	with stainless housing & silicon insert 4mm height	with stainless housing & silicon insert 5mm height

BALL HOUSING MINOR / BALL INSERT SILICON



Cat. No.	BHM-5032	BIS-0025
Designation	Stainless housing	Silicon insert



Cat. No.	OLH 0035
Designation	Orienting Lead Holder

4 BALL ATTACHMENT

Color no. 4
Internal Hex

ITL DENTAL

Prosthetic Catalog

TEMPORARY AESTHETIC ABUTMENTS

Includes a Retaining Screw

Abutments for temporary restoration made of biocompatible material PEEK. Polyether ether Ether Ketone is a colorless organic Thermoplastic polymer, proven to provide long term service.

STRAIGHT LEVEL MINOR - PEEK 3.5 Platform



Cat. No.	SLM-1110P	SLM-1220P	SLM-1330P
Designation	1mm shoulder	2mm shoulder	2.5mm shoulder

TEMPORARY TITANIUM ABUTMENT 3.5 Platform



Cat. No.	SMT-1210	SMT-1210R
Designation	Engaging	Non Engaging



ANGULAR CURVE MINOR - PEEK Platform 15° 3.5



Cat. No.	ACM-1115-10P	ACM-1215-20P	ACM-1215-30P	ACM-1315-40P
Designation	1mm Aesthetic shoulder	2mm Aesthetic shoulder	3mm Aesthetic shoulder	4mm Aesthetic shoulder

ANGULAR CURVE MINOR - PEEK 3.5 Platform 25°



Cat. No.	ACM-1125-10P	ACM-1225-20P
Designation	1mm Aesthetic shoulder	2mm Aesthetic shoulder

IMMEDIATE TEMPORARY CONICAL for immediate loading restoration 3.5 Platform



Cat. No.	ITC-0010	ITC-0020	ITC-0030	ITC-0040	ITC-0050	ITC-0060	CCP-00
Designation	1mm Aesthetic shoulder	2mm Aesthetic shoulder	3mm Aesthetic shoulder	4mm Aesthetic shoulder	5mm Aesthetic shoulder	6mm Aesthetic shoulder	PEEK Cover non engaging



5 TEMPORARY ABUTMENTS

Color no. 5
Internal Hex

ITL DENTAL

Prosthetic Catalog

STRAIGHT AESTHETIC ABUTMENTS

Includes a Retaining Screw

Ultra Slim Abutments are designed to be used in cases where the gaps between the implants are too narrow for standard abutments.

STRAIGHT CURVE MINOR

3.5 platform



Cat. No.	SCM-1110	SCM-1220	SCM-1330	SCM-1440
Designation	Aesthetic Shoulder 1mm height	Aesthetic Shoulder 2mm height	Aesthetic Shoulder 3mm height	Aesthetic Shoulder 4mm height

STRAIGHT LEVEL MINOR WITH HEX

platform 3.5



Cat. No.	SLM-1116	SLM-1226	SLM-1336
Designation	Straight Shoulder 1mm height	Straight Shoulder 2mm height	Straight Shoulder 3mm height

STRAIGHT LEVEL MINOR

3.5 platform



Cat. No.	SLM-1110	SLM-1220	SLM-1330
Designation	Straight Shoulder 1mm height	Straight Shoulder 2mm height	Straight Shoulder 3mm height

STRAIGHT LEVEL MINOR WITH GROOVES

platform 3.5



Cat. No.	SLM-1110-G	SLM-1220-G	SLM-1330-G
Designation	Straight Shoulder 1mm height	Straight Shoulder 2mm height	Straight Shoulder 3mm height

STRAIGHT SLIM MINOR

3.5 platform



Cat. No.	SSM-0006	SSM-0008	SSM-0010
Designation	Ultra Slim Abutment 6mm height	Ultra Slim Abutment 8mm height	Ultra Slim Abutment 10mm height

STRAIGHT MINOR

platform 3.5



Cat. No.	STM-0910	STM-1110	STM-1310	STM-1120
Designation	Standard Abutment 9mm height	Standard Abutment 11mm height	Standard Abutment 13mm height	Thick Abutment 11mm height

STRAIGHT CURVE WIDE

4.5 platform



Cat. No.	SCW-1110	SCW-1220	SCW-1330	SCW-1440
Designation	Aesthetic Shoulder 1mm height	Aesthetic Shoulder 2mm height	Aesthetic Shoulder 3mm height	Aesthetic Shoulder 4mm height

STRAIGHT WIDE

platform 4.5



Cat. No.	STW-1110
Designation	Standard Abutment 11mm height

STRAIGHT LEVEL WIDE

4.5 platform



SLW-1110	SLW-1220	SLW-1330
Straight Shoulder 1mm height	Straight Shoulder 2mm height	Straight Shoulder 3mm height

6 TITANIUM ABUTMENTS
Color no. 6
Internal Hex

ANGULAR AESTHETIC ABUTMENTS

Includes a Retaining Screw

SPECIFICATIONS

- The angular aesthetic abutment body functions as impression coping
- Includes the Prosthetic Screw
- Installs with 0.050 hex drivers (1.27mm)
- Non-rotational design for standard, internal-hex implants
- Made of Commercial grade 5 Titanium alloy (ASTM-F-136 02A COND A)



ANGULAR CURVE MINOR 3.5 Platform 15°



Cat. No.	ACM-1115-10	ACM-1215-20	ACM-1215-30	ACM-1315-40
Designation	1mm Aesthetic shoulder	2mm Aesthetic shoulder	3mm Aesthetic shoulder	4mm Aesthetic shoulder

ANGULAR CURVE WIDE 4.5 Platform 15°



Cat. No.	ACW-1115-10	ACW-1215-20
Designation	1mm Aesthetic shoulder	2mm Aesthetic shoulder

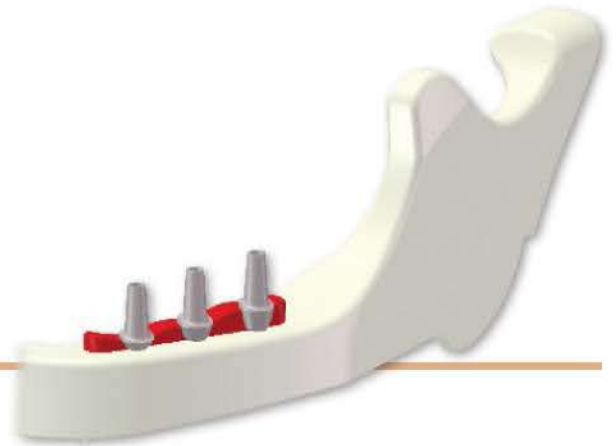

ANGULAR CURVE MINOR 3.5 Platform 25°



Cat. No.	ACM-1125-10	ACM-1225-20	ACM-1325-30	ACM-1425-40
Designation	1mm Aesthetic shoulder	2mm Aesthetic shoulder	3mm Aesthetic shoulder	4mm Aesthetic shoulder



6 TITANIUM ABUTMENTS

Color no. 6
Internal Hex

ANGULAR SMOOTH MINOR - LEAF



Cat. No.	ASM-0915 - LF	ASM-1115 - LF
Designation	Chopped edge	Chopped edge



Ultra Slim and **LEAF** treatment are for front teeth

ANGULAR SMOOTH MINOR - LEAF 3.5 Platform 25°



Cat. No.	ASM-0925 - LF	ASM-1125 - LF
Designation	Chopped edge	Chopped edge

ANGULAR SMOOTH THIN 3.5 Platform 15° & 25°



Cat. No.	AST-1115	AST-1125
Designation	Ultra Slim 15°	Ultra Slim 25°

ANGULAR SMOOTH MINOR 3.5 Platform 15°



Cat. No.	ASM-0915	ASM-1115	ASM-1315
Designation	Smooth shape	Smooth shape	Smooth shape

ANGULAR SMOOTH WIDE 4.5 Platform 15°



Cat. No.	ASW-1115
Designation	Smooth shape

ANGULAR SMOOTH MINOR 3.5 Platform 25°



Cat. No.	ASM-0925	ASM-1125	ASM-1325
Designation	Smooth shape	Smooth shape	Smooth shape



6 TITANIUM ABUTMENTS

Color no. 6
Internal Hex

STRAGHT ZIRCONIUM TITANIUM BASE ABUTMENTS 3.5 Platform



Cat. No.	SCZ-1010	SCZ-1120	SCZ-1230
Designation	1mm curve	2mm curve	3mm curve

ANGULAR ZIRCONIUM TITANIUM BASE ABUTMENTS 3.5 Platform



Cat. No.	ACZ-1015-10	ACZ-1115-20	ACZ-1215-30
Designation	1mm curve	2mm curve	3mm curve



PLASTIC ABUTMENTS FOR CASTING

PLASTICS STRAIGHT FOR CASTING 3.5 / 4.5 Platform



Cat. No.	PSM-0013	PSW-0013	PSM-6013	PSW-6013
Designation	Round Base	Round Base wide Cylinder	Hex Base	Hex Base wide Cylinder

8 CASTING ABUTMENTS

Color no. 8
Internal Hex

The Titanium / Plastic Abutments are for Investment and casting following conventional crown and bridge techniques. The Titanium / Plastic Abutments combine precision machined interface between the implant and the Abutment with the convenience of a castable plastic sleeve.

TITANIUM PLASTIC ABUTMENT 3.5 Platform



Cat. No.	TPA-1420	TPA-1420 R
Designation	Hex Base	Round Base

TITANIUM PLASTIC ABUTMENT 4.5 Platform



Cat. No.	TPA-1420 W	TPA-1420 WR
Designation	Hex Base wide platform	Round Base wide platform

Analogs are used for the fabrication of a master model.
They are replicas of the implant. All analogs are made of high grade stainless steel.

ANALOG STAINLESS



Cat. No.	AMS-1201	AWS-1201
Designation	Stainless body 3.5 Regular Platform	Stainless body 4.5 Wide Platform

ANALOG MLS SYSTEM

6 ANALOG

Color no. 9
Internal Hex



MLS SYSTEM

Cat. No.	AMU-1201
Designation	Analog for MLS System

ANALOG FOR OLS ABUTMENT SYSTEM



OLS ABUTMENT SYSTEM

Cat. No.	AWC-1301
Designation	Analog for OLS Abutment System

STRAIGHT MINOR SCANNING

3D Scanning Titanium Abutments
Suitable as Zirconium Interface with the Implant



Cat. No.	SMS - 0040	SMS - 6040	SWS - 0040	SWS - 6040
Designation	Round base 3.5 platform	Hex base 3.5 platform	Round base 4.5 platform	Hex base 4.5 platform

10 3D SCANNING INTERFACE
Color no. 10
Internal Hex



Cat. No.	SCSC - 1720
Designation	Long Screw for 3D Scanning Abutment

INTERNAL EXTERNAL ADAPTER

Platform; Regular 4.1, Wide 5.0

Internal hex :
regular 3.5

External hex:
Regular 4.1

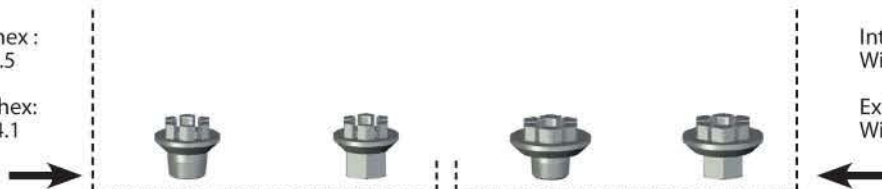

Internal hex :
Wide 4.5

External hex:
Wide 5.0

Cat. No.	INEX - 2427 R	INEX - 2427	INEX - 2433 WR	INEX - 2433 W
Designation	Round base 3.5 platform	Hex base 3.5 platform	Round base 4.5 platform	Hex base 4.5 platform



Cat. No.	SCIE - 2510	SCIE - 3009
Designation	Screw for Internal external 3.5 platform	Screw for Internal external 4.5 platform

ITL DENTAL

Prosthetic Catalog

Healing caps are used to maintain access through tissue during the healing phase. They are available in variety of heights and diameters to accommodate tissue depth.

HEALING CAP MINOR 3.5 Ultra Slim Platform



Cat. No.	HCM-3720	HCM-3730	HCM-3740	HCM-3750	HCM-3760	HCM-3770
Designation	Dia. 3.7 mm 2mm height	Dia. 3.7 mm 3mm height	Dia. 3.7 mm 4mm height	Dia. 3.7 mm 5mm height	Dia. 3.7 mm 6mm height	Dia. 3.7 mm 7mm height

* Recommended for narrow spaces

HEALING CAP MINOR 3.5 Slim Platform



Cat. No.	HCM-4020	HCM-4030	HCM-4040	HCM-4050	HCM-4060	HCM-4070
Designation	Dia. 4.6 mm 2mm height	Dia. 4.6 mm 3mm height	Dia. 4.6 mm 4mm height	Dia. 4.6 mm 5mm height	Dia. 4.6 mm 6mm height	Dia. 4.6 mm 7mm height

* Recommended for narrow spaces

HEALING CAP MINOR 3.5 Normal Platform



Cat. No.	HCM-5020	HCM-5030	HCM-5040	HCM-5050	HCM-5060	HCM-5070
Designation	Dia. 5 mm 2mm height	Dia. 5 mm 3mm height	Dia. 5 mm 4mm height	Dia. 5 mm 5mm height	Dia. 5 mm 6mm height	Dia. 5 mm 7mm height

* Recommended for angular restoration

HEALING CAP WIDE 4.5 Wide Platform



Cat. No.	HCW-6030	HCW-6040	HCW-6050	HCW-6060	HCW-6070	HCW-6080
Designation	Dia. 6 mm 3mm height	Dia. 6 mm 4mm height	Dia. 6 mm 5mm height	Dia. 6 mm 6mm height	Dia. 6 mm 7mm height	Dia. 6 mm 8mm height

11 HEALING CAP

Color no. 11
Internal Hex

SCREWS FOR ABUTMENTS



Cat. No.	SCA - 2385	SCS - 3095	SMU - 4023
Designation	For Angular Abutment	For Straight Abutment	For MLS Unit Sleeve

SCREWS FOR OVER DENTURE ABUTMENTS



Cat. No.	SCS - 3011	SCS - 3012	SCS - 3013
Designation	For Over denture Abutment ECA-6005	For Over Denture Abutment ECA-6015	For Over Denture Abutment ECA-6025

SCREWS FOR OPEN TRAY TRANSFER



Cat. No.	SCT - 3014	SCT - 3018	SCT - 3023
Designation	For MLS Unit Transfer	For Short Transfer Open Tray	For Transfer - Open Tray

SCREW FOR PLASTIC ABUTMENTS



Cat. No.	SCP-2580	SCA-2565
Designation	For Straight Plastic Abutment	For Angular Plastic Abutment

SCREW FOR CLOSE TRAY TRANSFER



Cat. No.	SCT - 2213
Designation	For Close tray Transfer



12 PROSTHETIC SCREWS

Color no. 12
Internal Hex

TRANSFER IMPRESSION COPING

Includes a Retaining Screw



TRANSFER MINOR STAINLESS
open tray Transfer
3.5 Platform



Cat. No.	TMS-1301	TSS - 1001	TMS-1001
Designation	Stainless body Long Design	Stainless body Slim design	Stainless body Short Design

TRANSFER WIDE STAINLESS
Open Tray Transfer
4.5 Platform



Cat. No.	TWS-1301
Designation	Stainless body Long Design

TRANSFER MINOR CLOSE
close tray transfer Abutment
3.5 Platform



Cat. No.	TMC-0910	TMC-0920	TMC-0930	TMC-0940	TMC-0950
Designation	Titanium body 1mm Aesthetic shoulder	Titanium body 2mm Aesthetic shoulder	Titanium body 3mm Aesthetic shoulder	Titanium body 4mm Aesthetic shoulder	Titanium body 5mm Aesthetic shoulder

* Plastic cap included

TRANSFER MATCHED PLASTIC
Close tray transfer plastic cap



Cat. No.	TMP-0008	TMP-0010
	low level plastic cap	high level plastic cap



Titanium body
Tin coated

TRANSFER WIDE CLOSE
close tray transfer Abutment
4.5 Platform



Cat. No.	TWC-0910	TWC-0920	TWC-0930	TWC-0940	TWC-0950
Designation	Titanium body 1mm Aesthetic shoulder	Titanium body 2mm Aesthetic shoulder	Titanium body 3mm Aesthetic shoulder	Titanium body 4mm Aesthetic shoulder	Titanium body 5mm Aesthetic shoulder

* Plastic cap included

13 TRANSFER

Color no. 13
Internal Hex

Prosthetic Catalog Index

Implant Items		36 - 44
Section 24	OLS	36
Section 25	MLS SYSTEM RESTORATION	37
Section 26	BALL ATTACHMENT ABUTMENTS	38
Section 27	STRAIGHT AESTHETIC ABUTMENTS	39
Section 28	ZIRCONIUM ABUTMENTS	40
Section 29	TITANIUM ABUTMENTS	41
Section 30	ANALOGS	42
Section 31	HEALING CAPS	43
Section 32	TRANSFERS	44

STRAIGHT OLS ABUTMENT SYSTEM

Over Denture Attachment in connection with implants

OLS ABUTMENT SYSTEM



OLS ABUTMENT SYSTEM FOR EXTERNAL HEX

Abutment bases in connection with implants
4.1 regular platform



Cat. No.	WCRE-4110	WCRE-4120	WCRE-4130	WCRE-4140	WCRE-4150	WCRE-4160
Designation	1mm Aesthetic Height	2mm Aesthetic Height	3mm Aesthetic Height	4mm Aesthetic Height	5mm Aesthetic Height	6mm Aesthetic Height

* Recommended tightening torque 20-25Ncm.

for FULL SET add SPE to Cat. No.

OLS ABUTMENT SYSTEM REGULAR -... - SET PEEK

Abutment bases with peek attachment and housing covers
4.1 regular platform



Cat. No.	WCRE-4110 - SPE	WCRE-4120 - SPE	WCRE-4130 - SPE	WCRE-4140 - SPE	WCRE-4150 - SPE	WCRE-4160 - SPE
Designation	0mm Aesthetic Height	1mm Aesthetic Height	2mm Aesthetic Height	3mm Aesthetic Height	4mm Aesthetic Height	5mm Aesthetic Height



OLS ABUTMENT SYSTEM- ACCESSORIES



Cat. No.	WCH-5628	WCH-4823	WCP-2348-H	WCPS-2348-H	WCP-2348	SCH-8540	TWC-1105	WCT-900	AWC-1301
Designation	STAINLESS STEEL HOUSING COVER	STAINLESS STEEL HOUSING	Hard Housing PEEK Attachment	Soft Housing PEEK Attachment	DIRECT PEEK Attachment	SILICON Sealed RING	TRANSFER for OLS	OLS Tool	ANALOG for OLS

MLS SYSTEM STRAIGHT AESTHETIC ABUTMENTS

Abutments with smooth, non locking surface for MLS System restorations

AESTHETIC MINOR UNIT Straight MLS System 4.1 regular platform

TOOL FOR EXTERNAL MULTI UNIT



Cat. No.	ERU-4110	ERU-4120	ERU-4130
Designation	1mm height	2mm height	3mm height



Cat. No.	TEM-0604
Designation	Tool for External Multi Unit



SMU-4023
Screw for Multi Unit Sleeve

MLS SYSTEM ACCESORIES



Cat. No.	PSU-0032	TSU-1250	TMU-0532	TMU-1200	TMU-8005	WQP-0011	HCC-4550	AMU-1201	SSU-1648
Designation	Plastic Sleeve screw included	Titanium Sleeve screw included	Titanium Short Sleeve screw included	Open Tray Transfer screw included	Close tray Transfer	Plastic for Close tray Transfer	Healing cap for Multi Unit	Analog for Multi Unit	3D Scanning Device

BALL ATTACHMENT ABUTMENTS

Over Denture Ball Attachment in Connection with Implants

BALL REGULAR STRAIGHT 4.1 Platform Dia. 4.3 mm



Cat. No.	BRSE-4120	BRSE-4130	BRSE-4140	BRSE-4150	BRSE-4160
Designation	without cap 2mm height	without cap 3mm height	without cap 4mm height	without cap 5mm height	without cap 6mm height

BALL MINOR SET -...- SILICON 4.1 Platform Dia. 4.3 mm

FULL SET



Cat. No.	BRSE-4120-S	BRSE-4130-S	BRSE-4140-S	BRSE-4150-S	BRSE-4160-S
Designation	with stainless housing & silicon insert	with stainless housing & silicon insert	with stainless housing & silicon insert	with stainless housing & silicon insert	with stainless housing & silicon insert

BALL HOUSING MINOR / BALL INSERT SILICON



Cat. No.	BHM-5032	BIS-0025
Designation	Stainless housing	Silicon insert

26 BALL ATTACHMENT
 Extended Hex
 Color no. 26
 External hex

STRAIGHT AESTHETIC ABUTMENTS

Includes a Retaining Screw

SPECIFICATIONS

- The angular aesthetic Abutment body functions as impression copying
- Includes the Prosthetic Screw
- Installs with 0.050 Hex Driver (1.27mm)
- Non-rotational design for standard, internal-hex implants
- Made of Commercial grade 5 Titanium alloy (ASTM-F-136 02A COND A)



STRAIGHT LEVEL EXTERNAL ABUTMENT 4.1 Regular platform



Cat. No.	SLE-R09-10	SLE-R10-20	SLE-R11-30
Designation	1mm Straight shoulder	2mm Straight shoulder	3mm Straight shoulder



15° ANGULAR CURVE EXTERNAL ABUTMENT 4.1 Regular platform



Cat. No.	ACE-R15-10	ACE-R15-20	ACE-R15-30
Designation	1mm Aesthetic shoulder	2mm Aesthetic shoulder	3mm Aesthetic shoulder

Our ultra Slim Abutments are designed to be used in cases where the gaps between implants are too narrow for standard abutments.

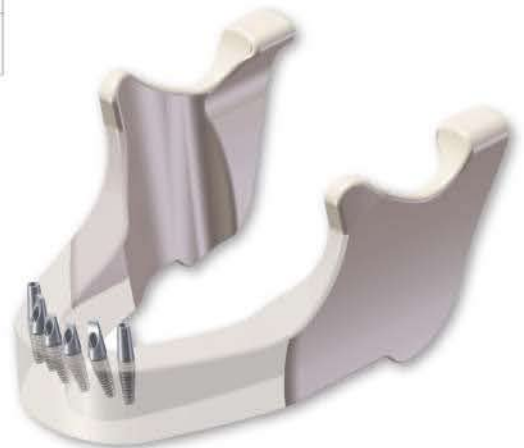

STRAIGHT ZIRCONIUM TITANIUM BASE ABUTMENTS 4.1 Platform



	SRZE-4110	SRZE-4120	SRZE-4130
Designation	1mm curve	2mm curve	3mm curve

ANGULAR ZIRCONIUM TITANIUM BASE ABUTMENTS 4.1 Platform



Cat. No.	ARZE-4115-10	ARZE-4115-20	ARZE-4115-30
Designation	1mm curve	2mm curve	3mm curve

Cat. No.



28 ZIRCONIA ABUTMENTS
 Extended Hex
 Color no. 28
 External hex

The Titanium / Plastic Abutment are for Investment and casting following conventional crown and bridge techniques.
 The Titanium / Plastic Abutments combine precision machined interface between the implant and the Abutment with the convenience of a castable plastic sleeve.

TITANIUM PLASTIC CASTING ABUTMENT 4.1 Regular platform



Cat. No.	TPAE-1220	TPAE-1220-R
Designation	Hex Base Titanium body	Non Ingaging Titanium body

TITANIUM PLASTIC CASTING ABUTMENT 5.0 Wide platform



Cat. No.	TPAWE-1220	TPAE-1220-R
Designation	Hex Base Titanium body	Non Ingaging Titanium body

29 CASTING ABUTMENTS
 Color no. 29
 External hex

Analogs are used for the fabrication of a master model.
They are replicas of the implant. All analogs are made of high grade stainless steel.

ANALOG FOR EXTERNAL HEX 4.1 / 5.0 platform



Cat. No.	AES-1241	AEWS-1251
Designation	Regular 4.1 platform Stainless body	Wide 5.0 platform Stainless body



30
ANALOG
External Hex

Color no. 30
External hex.

ANALOG MULTI UNIT

MLS SYSTEM



Cat. No.	AMU-1201
Designation	Analog for Multi Unit

ANALOG FOR OLS ABUTMENT SYSTEM

OLS ABUTMENT SYSTEM



Cat. No.	AWC-1301
Designation	Analog for OLS

Healing caps are used to maintain access through tissue during the healing phase. They are available in variety of heights and diameters to accommodate tissue depth.

HEALING CAP REGULAR PLATFORM 4.1 platform



Cat. No.	HCRE-5030	HCRE-5050
Designation	Dia. 5 mm 3mm height	Dia. 5 mm 5mm height

HEALING CAP WIDE PLATFORM 5.0 platform



Cat. No.	HCWE-6030	HCWE-6050
Designation	Dia. 5 mm 3mm height	Dia. 6 mm 5mm height



TRANSFERS IMPRATION COPYING

Includes a Retaining Screw



OPEN TRAY TRANSFER



Cat. No.	TREO-1101	TWEO-1101
Designation	Stainless body 4.1 platform	Stainless body 5.0 platform

TRANSFER WIDE CLOSE

close tray transfer Abutment
4.1 Regular Platform



Cat. No.	TCER-0910	TCER-0930
Designation	Titanium body 1mm Aesthetic shoulder	Titanium body 3mm Aesthetic shoulder

* Plastic cap included



Titanium body
Tin coated

TRANSFER MATCHED PLASTIC

Close tray transfer plastic cap



Cat. No.	TMP-0008	TMP-0010
Designation	low level plastic cap	high level plastic cap

32 TRANSFER
Extended Hex

Color no. 32
External hex

Prosthetic Catalog Index

Tri-Lobe

Implant Items		46 - 62
Section 14	OLS ABUTMENT SYSTEM TRI-LOBE	46 - 47
Section 15	MLS SYSTEM	48 - 51
Section 16	MLS SYSTEM RESTORATION	52 - 53
Section 17	BALL ATTACHMENT	54 - 55
Section 18	ZIRCONIUM ABUTMENTS	56
Section 19	AESTHETIC ABUTMENTS	57 - 58
Section 20	CASTING ABUTMENTS	59
Section 21	ANALOG	60
Section 22	3D SCANNING INTERFACE	61
Section 23	HEALING CAP	62

STRAIGHT OLS ABUTMENT SYSTEM

Over Denture Attachment in connection with implants

OLS ABUTMENT SYSTEM

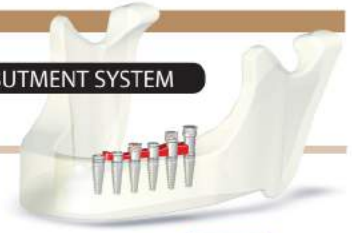

OLS ABUTMENT SYSTEM MINOR - RETAINED OVER DENTURE ABUTMENTS

Abutment bases in connection with implants
3.5 regular Platform

Cat. No.	WCR-0000	WCR-0010	WCR-0020	WCR-0030	WCR-0040	WCR-0050
Designation	0mm Aesthetic Height	1mm Aesthetic Height	2mm Aesthetic Height	3mm Aesthetic Height	4mm Aesthetic Height	5mm Aesthetic Height

for FULL SET add SPE to Cat No.

OLS ABUTMENT SYSTEM MINOR -... - SET PEEK

Abutment bases with peek attachment and housing covers
3.5 Platform

FULL SET

Cat. No.	WCR-0000 - SPE	WCR-0010 - SPE	WCR-0020 - SPE	WCR-0030 - SPE	WCR-0040 - SPE	WCR-0050 - SPE
Designation	0mm Aesthetic Height	1mm Aesthetic Height	2mm Aesthetic Height	3mm Aesthetic Height	4mm Aesthetic Height	5mm Aesthetic Height

14 OLS ABUTMENT SYSTEM Tri-Lobe
 Color no. 14

OLS ABUTMENT SYSTEM- ACCESSORIES

Cat. No.	WCH-5628	WCH-4823	WCP-2348-H	WCPS-2348-H	WCP-2348	SCH-8540	TWC-1105	WCT-900	AWC-1301
Designation	STAINLESS STEEL HOUSING COVER	STAINLESS STEEL HOUSING	Hard Housing PEEK Attachment	Soft Housing PEEK Attachment	DIRECT PEEK Attachment	SILICON Sealed RING	TRANSFER for OLS	OLS Tool	ANALOG for OLS

ANGULAR OLS ABUTMENT SYSTEM CONCEPT 9°, 18°, 30°

OLS Over Denture Attachment - SETS



OLS ABUTMENT SYSTEM

ON

MLS SYSTEM



OLS ABUTMENT SYSTEM ANGULAR MLS SYSTEM CONCEPT 9°
OLS Angular Over Denture Attachment - SET
4.3 Regular Platform

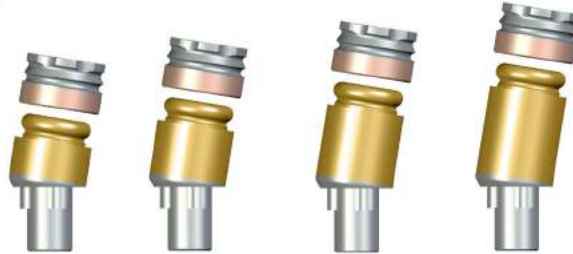

Cat. No.	WCA-0920 - R	WCA-0930 - R	WCA-0940 - R	WCA-0950 - R
Designation	9° OLS angular MLS system 2 mm Height	9° OLS angular MLS system 3 mm Height	9° OLS angular MLS system 4 mm Height	9° OLS angular MLS system 5 mm Height

Cat. No.	OLH 0035
Designation	Orienting Lead Holder

OLS ABUTMENT SYSTEM ANGULAR MULTI SYSTEM CONCEPT 18°
OLS Angular Over Denture Attachment - SET
4.3 Regular Platform



Cat. No.	WCA-1820 - R	WCA-1830 - R	WCA-1840 - R	WCA-1850 - R
Designation	18° OLS angular MLS system 2 mm Height	18° OLS angular MLS system 3 mm Height	18° OLS angular MLS system 4 mm Height	18° OLS angular MLS system 5 mm Height

OLS ABUTMENT SYSTEM ANGULAR MULTI SYSTEM CONCEPT 30°
OLS Angular Over Denture Attachment - SET
4.3 Regular Platform

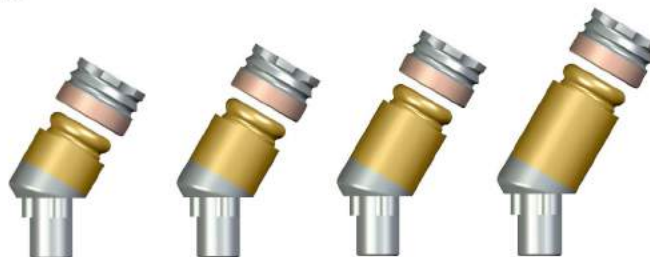

Cat. No.	WCA-3020 - R	WCA-3030 - R	WCA-3040 - R	WCA-3050 - R
Designation	30° OLS angular MLS system 2 mm Height	30° OLS angular MLS system 3 mm Height	30° OLS angular MLS system 4 mm Height	30° OLS angular MLS system 5 mm Height



ITL DENTAL

Prosthetic Catalog

MLS SYSTEM

Concept

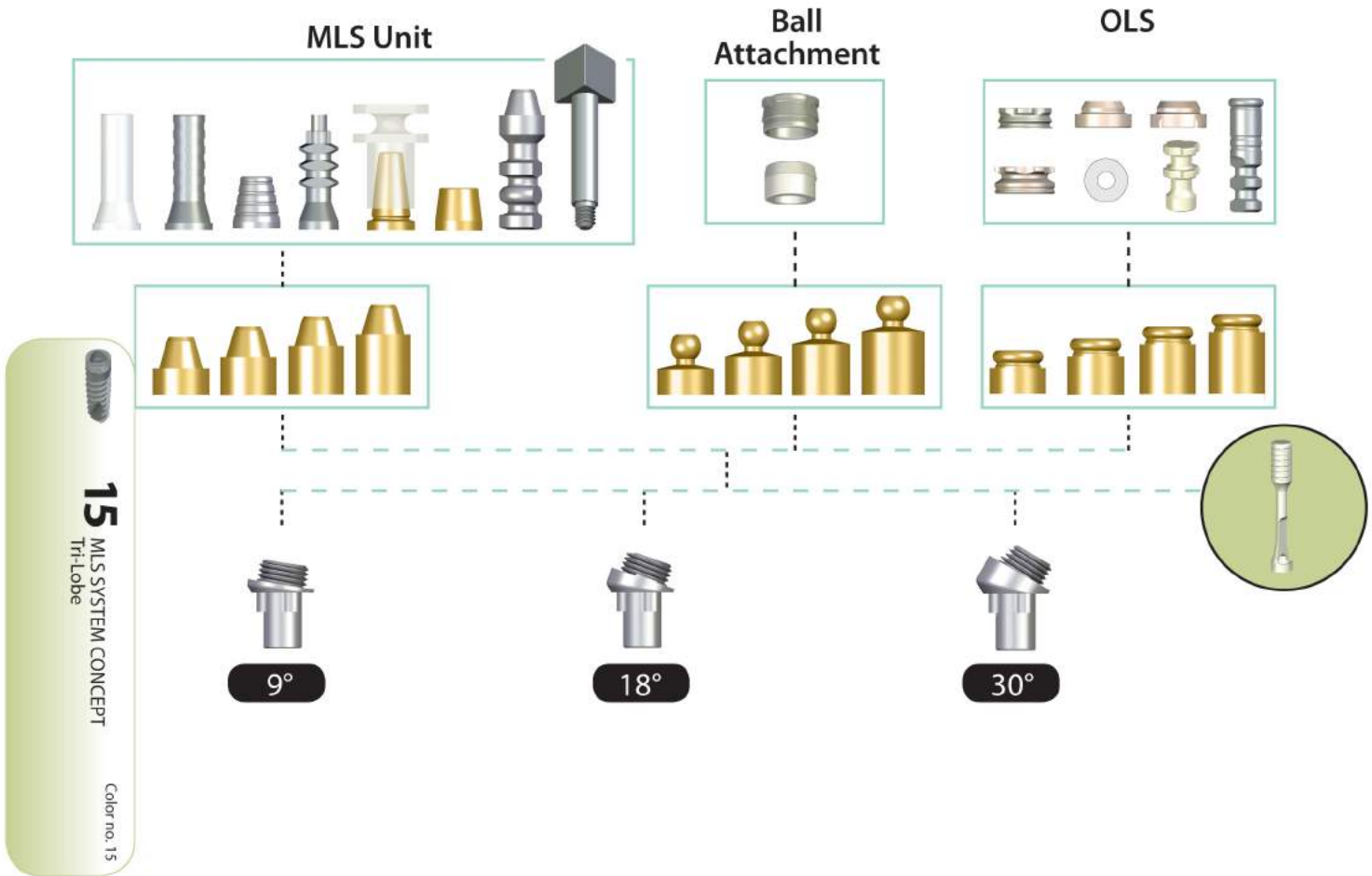

COMPATIBLE AESTHETIC ABUTMENTS

Internal Tri-Lobe

AESTHETIC REGULAR THREE UNIT - System Adaptor
 Angular MLS System Adaptor 9°, 18°, 30°
 4.3 Regular Platform Compatible Internal Tri-Lobe



Cat. No.	ERTU-0943	ERTU-1843	ERTU-3043
Designation	9° ANGLE MLS SYSTEM Adaptor	18° ANGLE MLS SYSTEM Adaptor	30° ANGLE MLS SYSTEM Adaptor

AESTHETIC REGULAR THREE UNIT - System Adaptor **INVERSE**
 Angular MLS System Adaptor 9°, 18°, 30°
 4.3 Regular Platform Compatible Internal Tri-Lobe



Cat. No.	ERTU-0943 - i	ERTU-1843 - i	ERTU-3043 - i
Designation	*inverse 9° ANGLE MLS SYSTEM Adaptor	*inverse 18° ANGLE MLS SYSTEM Adaptor	*inverse 30° ANGLE MLS SYSTEM Adaptor

15
MLS SYSTEM CONCEPT
Tri-Lobe

Color no. 15

OLS ABUTMENT SYSTEM CONNECTION
 OLS Connection for MLS System Concept



Cat. No.	WCC-0020	WCC-0030	WCC-0040	WCC-0050
Designation	2 mm CONNECTION MLS SYSTEM OLS	3 mm CONNECTION MLS SYSTEM OLS	4 mm CONNECTION MLS SYSTEM OLS	5 mm CONNECTION MLS SYSTEM OLS



OLS ABUTMENT SYSTEM



Cat. No.	WCH-5628	WCH-4823	WCP-2348-H	WCP5-2348-H	WCP-2348	SCH-8540	TWC-1105	WCT-900	AWC-1301
Designation	STAINLESS STEEL HOUSING COVER	STAINLESS STEEL HOUSING	Hard Housing PEEK Attachment	Soft Housing PEEK Attachment	DIRECT PEEK Attachment	SILICON Sealed RING	TRANSFER for OLS	OLS Tool	ANALOG for OLS

BALL MULTI ANGULAR

Ball attachment connection for MLS System Concept



Cat. No.	BMA-0020	BMA-0030	BMA-0040	BMA-0050
Designation	2 mm CONNECTION MLS SYSTEM BALL	3 mm CONNECTION MLS SYSTEM BALL	4 mm CONNECTION MLS SYSTEM BALL	5 mm CONNECTION MLS SYSTEM BALL

BALL Attachment- Accessories



Cat. No.	BHM-5032	BIS-0025
Designation	Stainless Steel Housing	Silicon Insert

MLS SYSTEM CONNECTION

Screwed in Connection for MLS System Concept



Cat. No.	MUC-0020	MUC-0030	MUC-0040	MUC-0050
Designation	2 mm CONNECTION MLS SYSTEM	3 mm CONNECTION MLS SYSTEM	4 mm CONNECTION MLS SYSTEM	5 mm CONNECTION MLS SYSTEM

MLS SYSTEM ACCESSORIES



Cat. No.	PSU-0032	TSU-1250	TMU-0532	TMU-1100	TMU-8005	WQP-0011	HCC-4450	AMU-1201	SSU-1624
Designation	Plastic Sleeve screw included	Titanium Sleeve screw included	Titanium Short Sleeve screw included	Open Tray Transfer screw included	Close tray Transfer	Plastic for Close tray Transfer	Healing cap for MLS System	Analog for MLS System	3D Scanning Device

ITL DENTAL

Prosthetic Catalog

The MLS SYSTEM is designed to fit all angular over denture applications.

These unique MLS SYSTEM Adaptors expand the application range of the ITL Dental over denture line, ANGULAR BALL ATTACHMENT, ANGULAR MULTI UNIT and ANGULAR OLS ABUTMENT SYSTEM.

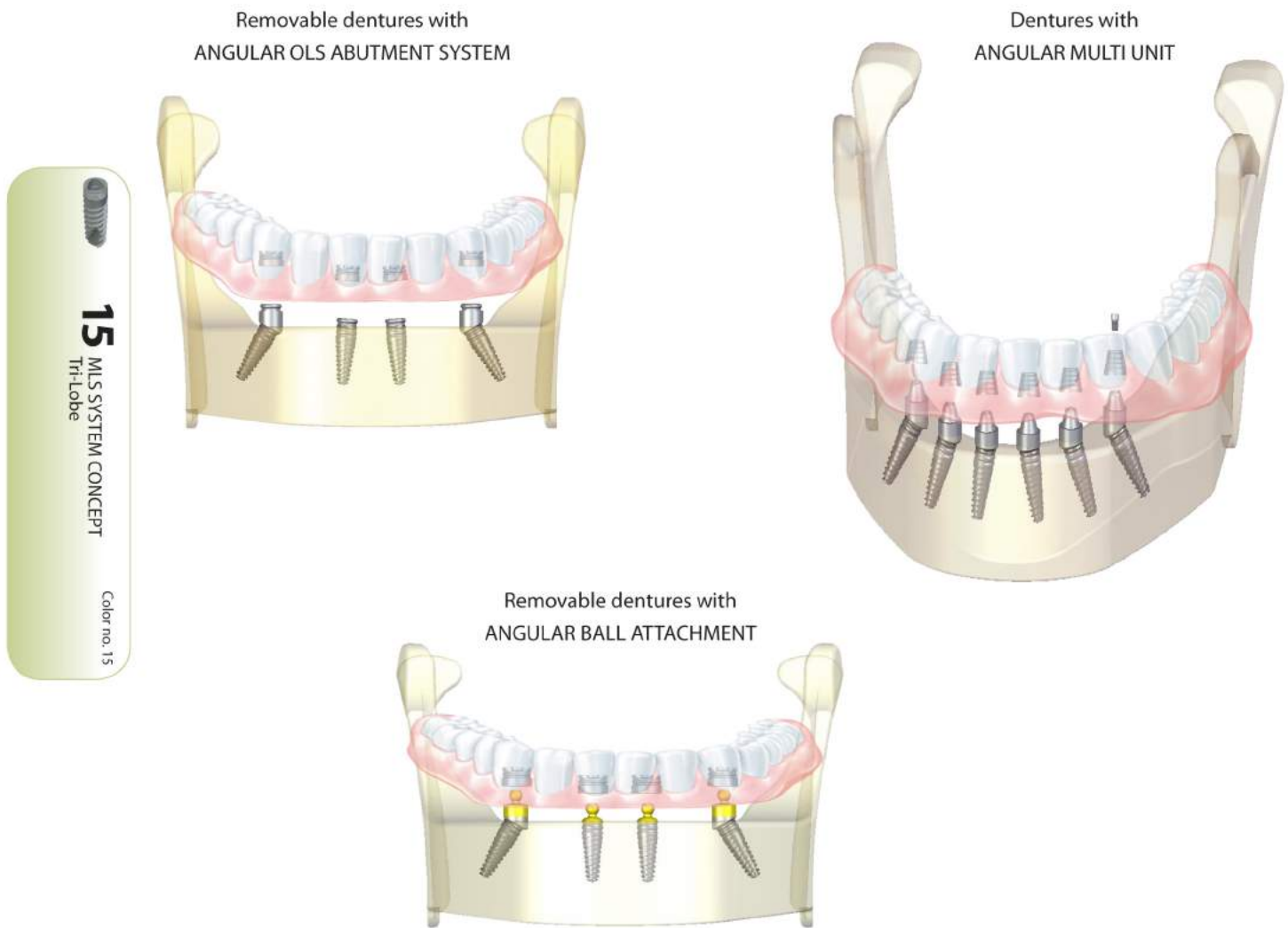

MLS SYSTEM UNIT STRAIGHT AESTHETIC ABUTMENTS

Abutments with smooth, non locking surface for MLS SYSTEM-Unit restorations

AESTHETIC MINOR UNIT
Straight MLS SYSTEM-Unit
4.3 Regular Platform



Cat. No.	SRTU-4310	SRTU-4320	STRU-4330
Designation	1mm height	2mm height	3mm height

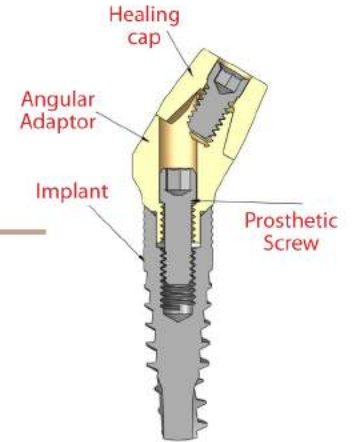

MLS SYSTEM

NOTE: The screw geometry was carefully designed and optimized to allow safe tightening and long service. Special attention must be paid while tightening the screw. Make sure to use 0.050 Hex Driver with edges that do not show wear. It is recommended to purchase additional screws.



SMU-4023
Screw For MLS
System Unit
Sleeve
See Manual instruction

MLS SYSTEM-UNIT ACCESSORIES



Cat. No.	PSU-0032	TSU-1250	TMU-0532	TMU-1200	TMU-8005	WQP-0011	HCC-4450	AMU-1201	SSU-1628
Designation	Plastic Sleeve screw included	Titanium Sleeve screw included	Titanium Short Sleeve screw included	Open Tray Transfer	Close tray Transfer	Plastic for Close tray Transfer	Healing cap for MLS System Unit	Analog for MLS System Unit	3D Scanning Device

16 MLS SYSTEM RESTORATION Tri-Lobe
Color no. 16

ANGULAR MLS SYSTEM CONCEPT 9°,18°,30° MLS System Unit Over Denture Attachment



MLS SYSTEM

9° ANGULAR MLS SYSTEM UNIT CONCEPT

Aesthetic MLS System Unit Angular Over Denture Attachment - SET
4.3 Regular Platform



← 2 Pieces

Cat. No.	EMA-0921-R	EMA-0931-R	EMA-0941-R	EMA-0951-R
Designation	9° Angular MLS system - H02	9° Angular MLS system - H03	9° Angular MLS system - H04	9° Angular MLS system - H05

18° ANGULAR MLS SYSTEM UNIT CONCEPT

Aesthetic MLS Unit Angular Over Denture Attachment
4.3 Regular Platform



← 2 Pieces

Cat. No.	EMA-1831-R	EMA-1841-R	EMA-1851-R	EMA-1861-R
Designation	18° Angular MLS system - H03	18° Angular MLS system - H04	18° Angular MLS system - H05	18° Angular MLS system - H06

30° ANGULAR MLS SYSTEM UNIT CONCEPT

Aesthetic MLS Unit Angular Over Denture Attachment
4.3 Regular Platform

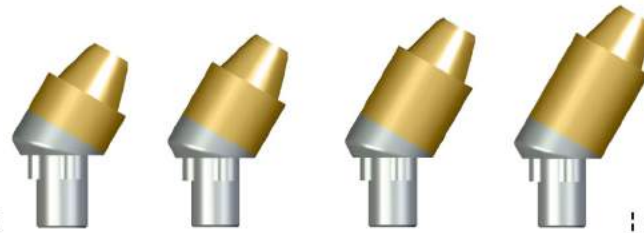

← 2 Pieces

Cat. No.	EMA-3031-R	EMA-3041-R	EMA-3051-R	EMA-3061-R
Designation	30° Angular MLS system - H03	30° Angular MLS system - H04	30° Angular MLS system - H05	30° Angular MLS system - H06



16 MLS SYSTEM RESTORATION Tri-Lobe
Color no. 16

* MLS-UNIT ACCESORIES → SEE PREVIOUS PAGE

ANGULAR BALL ATTACHMENT - SET

Over Denture Ball Attachment in connection with implants



9° BALL MINOR ANGULAR MLS SYSTEM CONCEPT
4.3 Regular Platform



Cat. No.	BRA-0920-S	BRA-0930-S	BRA-0940-S	BRA-0950-S
Designation	with stainless housing & silicon insert 2mm height	with stainless housing & silicon insert 3mm height	with stainless housing & silicon insert 4mm height	with stainless housing & silicon insert 5mm height

18° BALL MINOR ANGULAR MLS SYSTEM CONCEPT
4.3 Regular Platform



Cat. No.	BRA-1820-S	BRA-1830-S	BRA-1840-S	BRA-1850-S
Designation	with stainless housing & silicon insert 2mm height	with stainless housing & silicon insert 3mm height	with stainless housing & silicon insert 4mm height	with stainless housing & silicon insert 5mm height

30° BALL MINOR ANGULAR MLS SYSTEM CONCEPT
4.3 Regular Platform



Cat. No.	BRA-3020-S	BRA-3030-S	BRA-3040-S	BRA-3050-S
Designation	with stainless housing & silicon insert 2mm height	with stainless housing & silicon insert 3mm height	with stainless housing & silicon insert 4mm height	with stainless housing & silicon insert 5mm height

BALL HOUSING MINOR / BALL INSERT SILICON



Cat. No.	BHM-5032	BIS-0025
Designation	Stainless housing	Silicon insert



Cat. No.	OLH 0035
Designation	Orienting Lead Holder

17 BALL ATTACHMENT
Tri-Lobe
Color no. 17

Over Denture Straight Ball Attachment in Connection with Implants

BALL REGULAR STRAIGHT 4.3 Regular Platform



Cat. No.	BRST-4010	BRST-4020	BRST-4030
Designation	without cap 1mm height	without cap 2mm height	without cap 3mm height

* Recommended tightening torque 20-25Ncm.



17

BALL ATTACHMENT
Tri-Lobe

Color no. 17

BALL REGULAR SET -...- SILICON 4.3 Regular Platform



Cat. No.	BRST-0010-S	BRST-0020-S	BRST-0030-S
Designation	with stainless housing & silicon insert	with stainless housing & silicon insert	with stainless housing & silicon insert

* Recommended tightening torque 20-25Ncm.

BALL HOUSING MINOR /BALL INSERT SILICON



Cat. No.	BHM-5032	BIS-0025
Designation	Stainless housing	Silicon insert

STRAIGHT ZIRCONIA TITANIUM BASE ABUTMENTS 4.3 Regular Platform



Cat. No.	SRZT-1010	SRZT-1120	SRZT-1230
Designation	1mm curve	2mm curve	3mm curve



18 ZIRCONIA ABUTMENTS
Tri-Lobe

Color no. 18

15° ANGULAR ZIRCONIA TITANIUM BASE ABUTMENTS 4.3 Regular Platform



Cat. No.	ARZT-1015-10	ARZT-1115-20	ARZT-1215-30
Designation	1mm curve	2mm curve	3mm curve

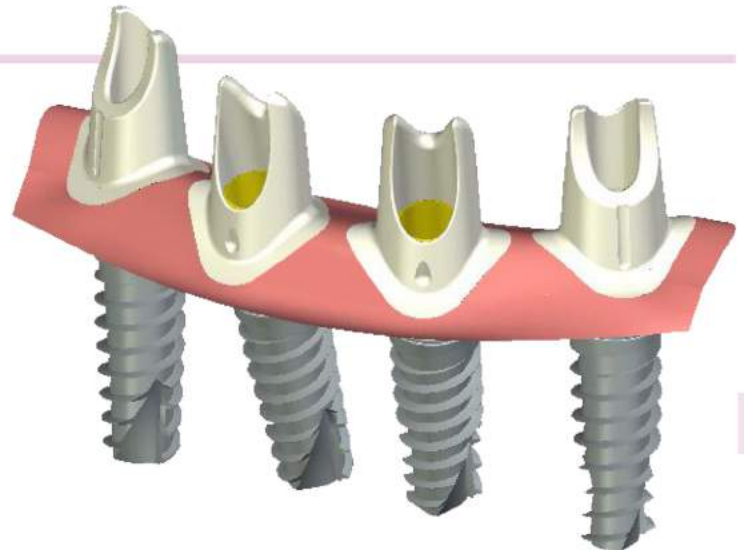

STRAIGHT CURVE NARROW Tri-Lobe 3.5 Narrow Platform



Cat. No.	SCNT-3500-10	SCNT-3500-30
Designation	1mm' Aesthetic shoulder	3mm' Aesthetic shoulder

19 COMPATIBLE AESTHETIC
 ABUTMENTS
 Tri-Lobe
 Color no. 19

STRAIGHT CURVE REGULAR Tri-Lobe 4.3 Regular Platform



Cat. No.	SCRT-4300-10	SCRT-4300-30
Designation	1mm' Aesthetic shoulder	3mm' Aesthetic shoulder

STRAIGHT CURVE WIDE Tri-Lobe 5 Wide Platform



Cat. No.	SCWT-5000-10	SCWT-5000-25
Designation	1mm' Aesthetic shoulder	2.5mm' Aesthetic shoulder

ITL DENTAL Prosthetic Catalog

ANGULAR CURVE NARROW THREE

← 3.5 Narrow Platform →



Cat. No.	ACNT-3515-10	ACNT-3515-30
Designation	1mm Aesthetic shoulder	3mm Aesthetic shoulder

INVERSE ANGULAR CURVE NARROW THREE



Cat. No.	ACNT-3515-10-i	ACNT-3515-30-i
Designation	*Inverse Abutment 1mm Aesthetic shoulder	*Inverse Abutment 3mm Aesthetic shoulder

ANGULAR CURVE REGULAR THREE

← 4.3 Regular Platform →



Cat. No.	ACRT-4315-10	ACRT-4315-30
Designation	1mm Aesthetic shoulder	3mm Aesthetic shoulder

INVERSE ANGULAR CURVE REGULAR THREE



Cat. No.	ACRT-4315-10-i	ACRT-4315-30-i
Designation	*Inverse Abutment 1mm Aesthetic shoulder	*Inverse Abutment 3mm Aesthetic shoulder

ANGULAR CURVE WIDE THREE

← 5 Wide Platform →



Cat. No.	ACWT-5015-05	ACWT-5015-30
Designation	0.5 mm Aesthetic shoulder	3mm Aesthetic shoulder

INVERSE ANGULAR CURVE WIDE THREE



Cat. No.	ACWT-5015-05-i	ACWT-5015-30-i
Designation	*Inverse Abutment 0.5mm Aesthetic shoulder	*Inverse Abutment 3mm Aesthetic shoulder

19 COMPATIBLE AESTHETIC ABUTMENTS Tri-Lobe

Color no. 19

ITL DENTAL

Prosthetic Catalog

The Titanium / Plastic Abutment are for Investment and casting following conventional crown and bridge techniques.

The Titanium / Plastic Abutments combine precision machined interface between the implant and the Abutment with the convenience of a castable plastic sleeve.

TITANIUM PLASTIC ABUTMENT

4.3 Regular Platform

5.0 Wide Platform



Cat. No.	TPAR-1420	TPAR-1420 R	TPAR-1420 W	TPAR-1420 WR
Designation	Hex Base Regular platform	Round Base Regular platform	Hex Base Wide platform	Round Base Wide platform



Analogs are used for the fabrication of a master model.
They are replicas of the implant. All analogs are made of high grade stainless steel.

ANALOG COMPATIBLE INTERNAL TRI-LOBE



Cat. No.	ANS-1135	ARS-1143	AWS-1150
Designation	Narrow Platform	Regular Platform	Wide Platform

ANALOG MLS SYSTEM



MLS SYSTEM

Cat. No.	AMU-1201
Designation	Analog for MLS System

ANALOG FOR OLS ABUTMENT SYSTEM



OLS ABUTMENT SYSTEM

Cat. No.	AWC-1301
Designation	Analog for OLS

21 ANALOG
Tri-Lobe

Color no. 21

STRAIGHT SCANNING ABUTMENT

Scanning Titanium Abutments for 3D
Suitable as Zirconium Interface with the Implant



Cat. No.	SNS - 3530	SRS - 4330	SWS - 5030
Designation	Narrow Platform 3.5	Regular Platform 4.3	Wide Platform 5



Cat. No.	SCSC - 7020
Designation	Long Screw for 3D Scanning Abutment

22

3D SCANNING INTERFACE
Tri-Lobe

Color no. 22

INTERNAL EXTERNAL ADAPTER 4.3 Regular Platform



Cat. No.	INEX - 2743R	INEX - 2743
Designation	Round Base	Internal Three Leg Fit

INTERNAL EXTERNAL ADAPTER 5.0 Wide Platform



Cat. No.	INEX - 2750R	INEX - 2750
Designation	Round Base	Internal Three Leg Fit

SCREW FOR INTERNAL / EXTERNAL 4.3 Regular Platform



Cat. No.	SRIE - 2543
Designation	Screw for Internal three 4.3 platform

SCREW FOR INTERNAL / EXTERNAL 5.0 Wide Platform



Cat. No.	SWIE - 3043
Designation	Screw for Internal three 5.0 platform

Healing caps are used to maintain access through tissue during the healing phase. They are available in variety of heights and diameters to accommodate tissue depth.

HEALING CAP REGULAR THREE 4.3 Regular Platform



Cat. No.	HCRT-5330	HCRT-5350
Designation	Dia. 5.3 mm 3mm height	Dia. 5.3 mm 5mm height

* Recommended for angular restoration



23
HEALING CAP
TFLobe

Color no. 23

HEALING CAP REGULAR THREE 4.3 Regular Platform



Cat. No.	HCRT-4330	HCRT-4350
Designation	Dia. 4.3 mm 3mm height	Dia. 4.3 mm 5mm height

* Recommended for narrow spaces